

Cross-sectional view of Wiesbaden channel in a swimming pool

Wear class B and water impact classes W3-I, W1-B and W2-B

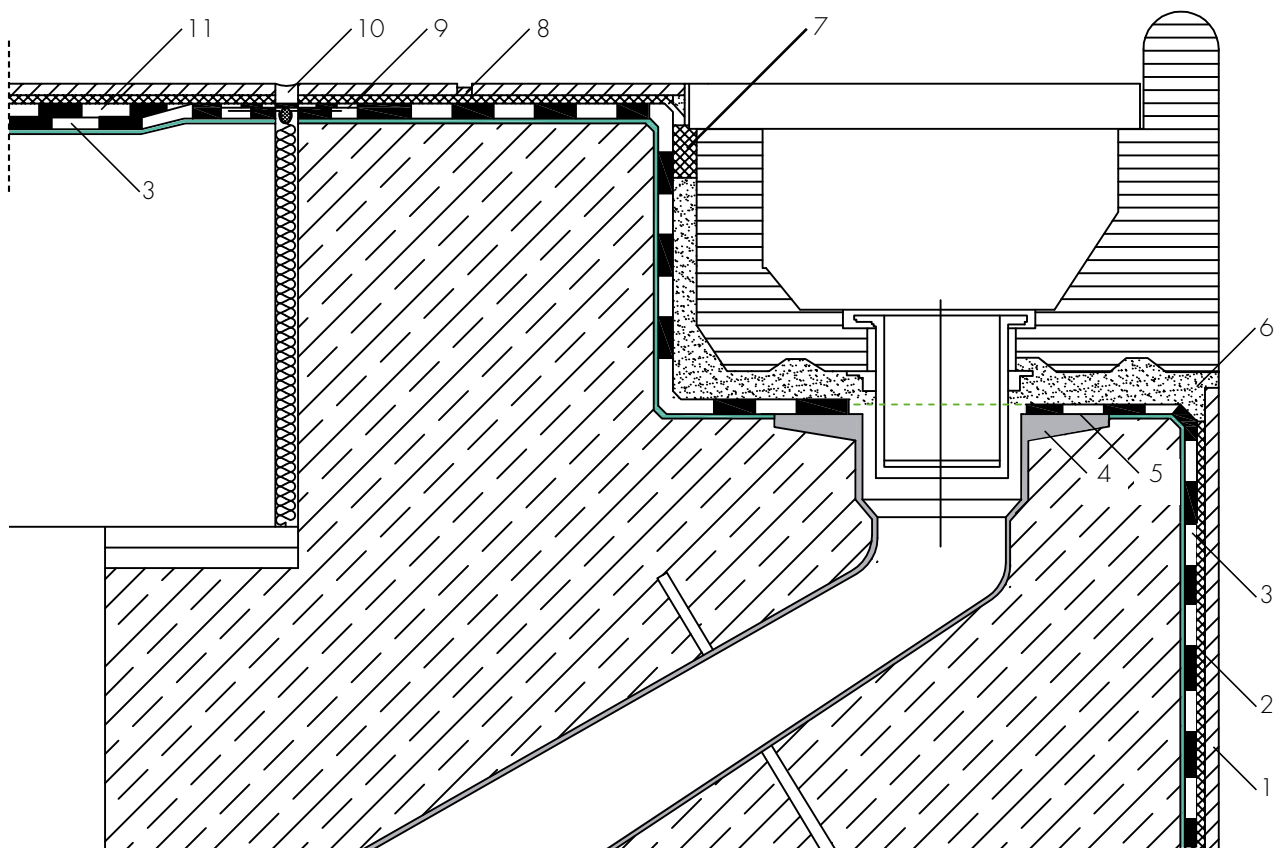

- 1 Tiles
- 2 UNIFIX-S3 thin-bed mortar
- 3 AQUAFIN-2K/M-PLUS/AQUAFIN-RS300*
- 4 PVC or stainless steel flange
- 5 In the area of the flange, ASO sealing sleeve floor as inlay in AQUAFIN-2K/M-PLUS / AQUAFIN-RS300*
- 6 Channel laid in the mortar bed from ASO-EZ2-PLUS, bond coat on gutter stone and substrate with ASOCRET-HB-flex
- 7 ASODUR-EP/FM capillary-breaking joint filler
- 8 ASODUR-DESIGN/HF05-Brillanfuge joint mortar
- 9 Inlaid ASO joint tape 2000-S, ASO-SR, ASO joint tape 2000, AQUAFIN-2K/M-PLUS / AQUAFIN-RS300*
- 10 ESCOSIL-2000-UW elastic grouting compound
- 11 Min. 10 cm overlapped waterproofing with AQUAFIN-2K/M-PLUS / AQUAFIN-RS300*

* water depth of up to 6 m